

VEHICLE TYPE

- Fire Fighting Truck
- Water Jetting Truck
- Vacuum Truck

TRANSMISSION CODE

3800 KGM vertical Split Shaft PTO is designed for Heavy Duty trucks with 3-stage. The gearbox can be installed as horizontal if needed. It can provide 100% of input speed. Control system can be pneumatic or mechanic. PTO shaft can be at differential side or cabin side. Second PTO output is an option. In case of double PTO, the output is requested, PTO outputs can be shifted independently. PTO outputs can be design with all ISO standard flanges as well as suitable housing for any kind of hydraulic pump. The cooling system can be mount on the gearbox. Engage/Disengage sensor can be installed to observe, if PTO is engaged or not, also RPM counter is another option.

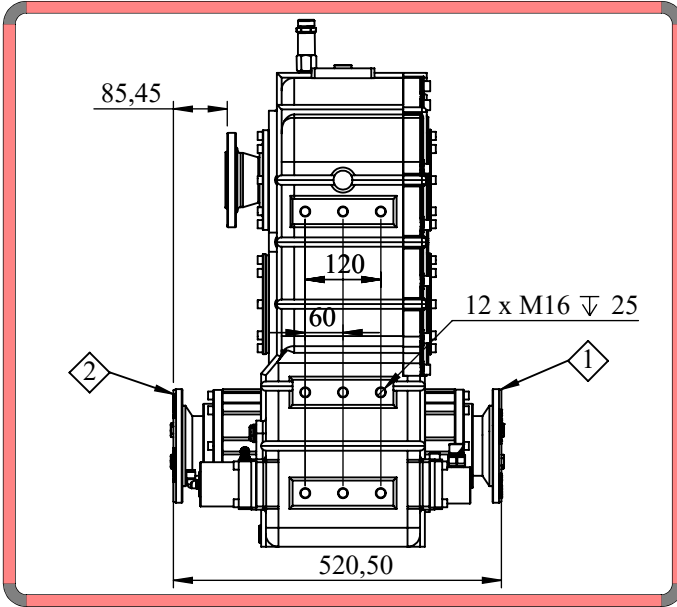
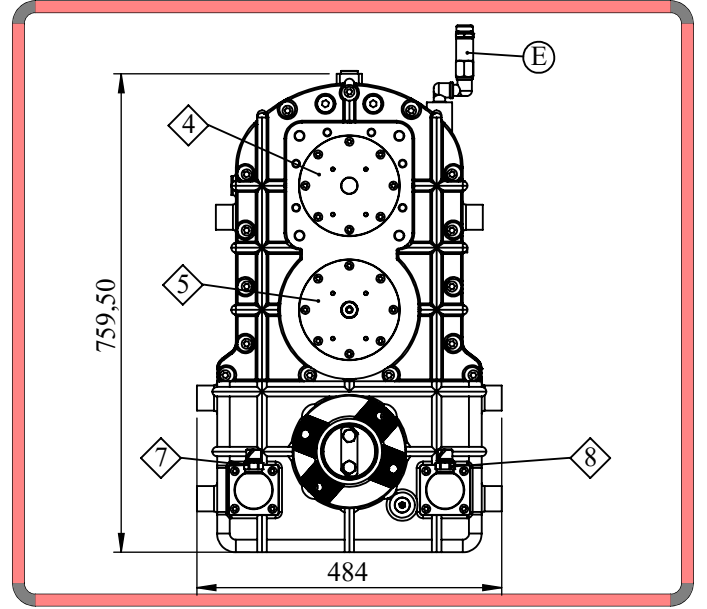
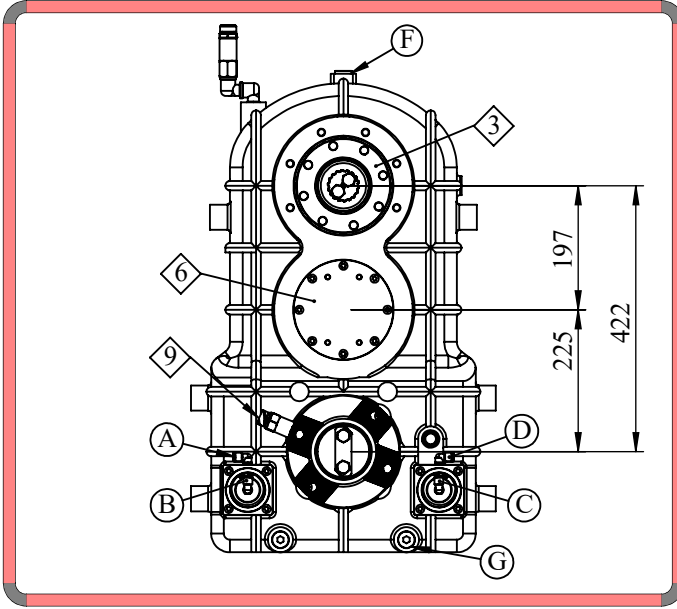

1	Main Gearbox Input Flange (ISO 7646 - 7647- 8667)
2	Differential Output Flange (ISO 7646 - 7647- 8667)
3	1st. Equipment Output
4	2nd. Equipment Output
5	3rd. Equipment Output
6	2nd. Equipment Output
7	Equipment On/Off Sensor (Ops.)
8	Main Drive On/Off Sensor (Ops.)
9	RPM Counter (Ops.)
A	Inter Air Engages The Main Drive
B	Inter Air Disables The Main Drive
C	Inter Air Engages The Equipment
D	Inter Air Disables The Equipment
E	Air Plug
F	Oil Filter Plug
G	Oil Drain Plug

TECHNICAL VALUES

	MAX VALUES	RATIO	WORKING RPM RANGE (MAX)
① & ②	38000 Nm	1/1	2500 - 3500 rpm
③ & ④	350 kW	1/1.3 - 1/1.7	2500 - 3500 rpm
⑤ & ⑥	350 kW	1/1.25	2500 - 3500 rpm

* Output Power ; The rpm and output power may vary. Contact KMS for exact working values.

Optimum Working Temperature	25° - 70°	WEIGHT	265 Kg
Short-term Working Temperature	75° - 80°	BODY MATERIAL	GGG 50
Risky Working Temperature	85° -	OIL TYPE & AMOUNT	SAE 90 - 10,5 Lt

